

Power Distribution Unit 12

(PDU-12)

The Thinklogical Power Distribution Unit 12 (PDU-12) provides twelve power outputs to Thinklogical products requiring a +5 volt external DC power input, eliminating the need for individual wall-wart style power adapters.

PDU12 Chassis, Part No. PDU-000012

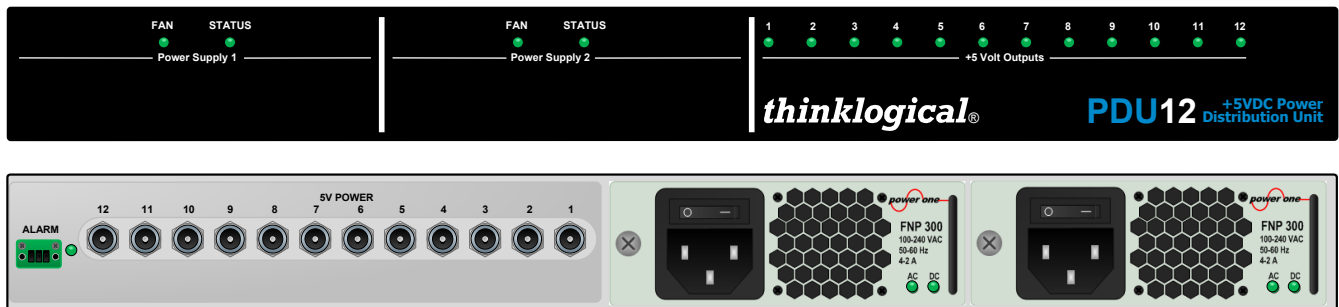

Each unit contains two redundant, hot-swappable AC/DC power supplies capable of load sharing, which plug into the rear of the chassis and have removable AC line cords. The rear panel features twelve DC Locking Power Jacks with a .100" diameter center pin. Each +5 volt output is capable of sourcing +5 volts \pm .25volts at a maximum of 4 amps.

Key Features:

- Twelve +5 volt DC outputs, each capable of delivering 4 amps
- Redundant AC/DC load sharing power supplies
- Front panel LED status indicators
- Rear panel LED system status indicator
- Rear panel 3-terminal dry contact alarm terminal connector
- Twelve 6' DC locking power connector cables included

Compatible with (but not limited to) the following Thinklogical products:

- VelocityDVI Extension System-3, -3R, -3A/V+, -3R AV+
- VelocityDVI Extension System-6, -6A/V
- Camera Fiber-Link Series
- USB 2.0 Fiber Optic Extender
- SDI Xtreme 3G, 3G+

Specifications

2 AC/DC Power Supply Voltage	100 – 240 VAC at a frequency of 50 - 60Hz
Source Voltage	+5 volts ±.25volts at a maximum of 4 amps
Dimensions	
Height	1RU / 1.72" (43.69 mm); Rack mountable
Depth	10.52" (267.08 mm)
Width	17.49" (444.29 mm)
Width (with mounting brackets)	19.03" (483.46 mm)
Tolerance	± .039"; 1 mm
Rear Panel Connectors	12 DC Locking Power Jacks (with .100 inch diameter center pin); Dry Contact Alarm
Dry Contact Alarm	1 Green/Red LED Reports: Power Supply 1 Fan status Power Supply 1 Power status Power Supply 2 Fan status Power Supply 2 Power status
Front Panel LEDs	+5 VDC output 1-12 Power status 1 green/red LED for Power Supply 1 fan status 1 green/red LED for Power Supply 1 power status 1 green/red LED for Power Supply 2 fan status 1 green/red LED for Power Supply 2 power status
Electrical Cables	12 green LEDs to indicate the status of each of the +5 VDC outputs. PWR-000006-R AC 3-wire line cord, 6FT (2) CBLA000050 DC power cable w/ locking connectors, 6FT (12) CBLA000051 DC power cable w/ one mini XLR connector, one locking connector, 6 FT (optional; supplied as required)
Operating Temp and Humidity	0° to 50°C (32° to 122 °F), 5% to 95% RH, non-condensing
Weight	7.5 lb (3.4 kg)
Shipping Weight	15 lb (6.8 kg)
Compliance	Approvals for US, Canada, and European Union
Warranty	12 months from date of shipment. Extended warranties available

Installation Example

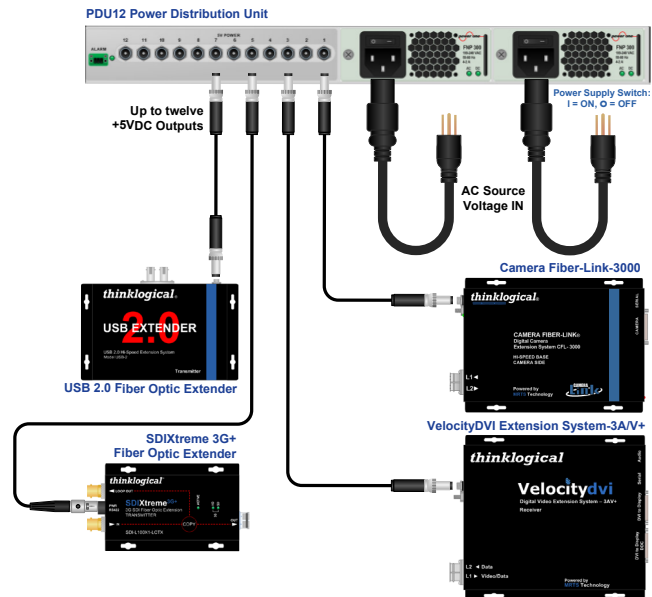

Ordering Information

Part Number	Description
PDU-000012	Power Distribution Unit