

# QUICK-START GUIDE

As used with Thinklogical's Velocitydvi Video Extension System-3 and the Velocityrgb Video Extension System-9

# router VX80 KVM Matrix Switch

Powered by  
MRTS Technology

The VX80 Router Critical Hardware Alarms: (Located at the top, left rear of the unit.)

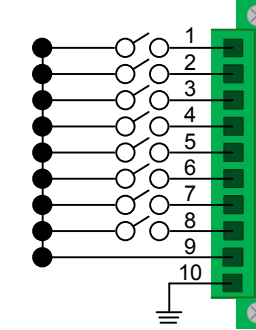

- POWER SUPPLY 1 (LEFT): Fan failure, temperature spikes, DC voltage and/or current out of range, AC power input interruption and module removed
- POWER SUPPLY 2 (RIGHT): Fan failure, temperature spikes, DC voltage and/or current out of range, AC power input interruption and module removed
- FANS: Individual fan monitoring
- TEMPERATURE WARNING: Chassis over temperature, multiple sensors
- TEMPERATURE SHUTDOWN: Chassis over temperature causing shutdown
- CPU: Card failure (Only with a redundant card)
- INPUT/OUTPUT CARDS: SFP+ failure, laser output fault
- ANY OF THE ABOVE
- COMMON
- GROUND

## Single-Head DVI Source

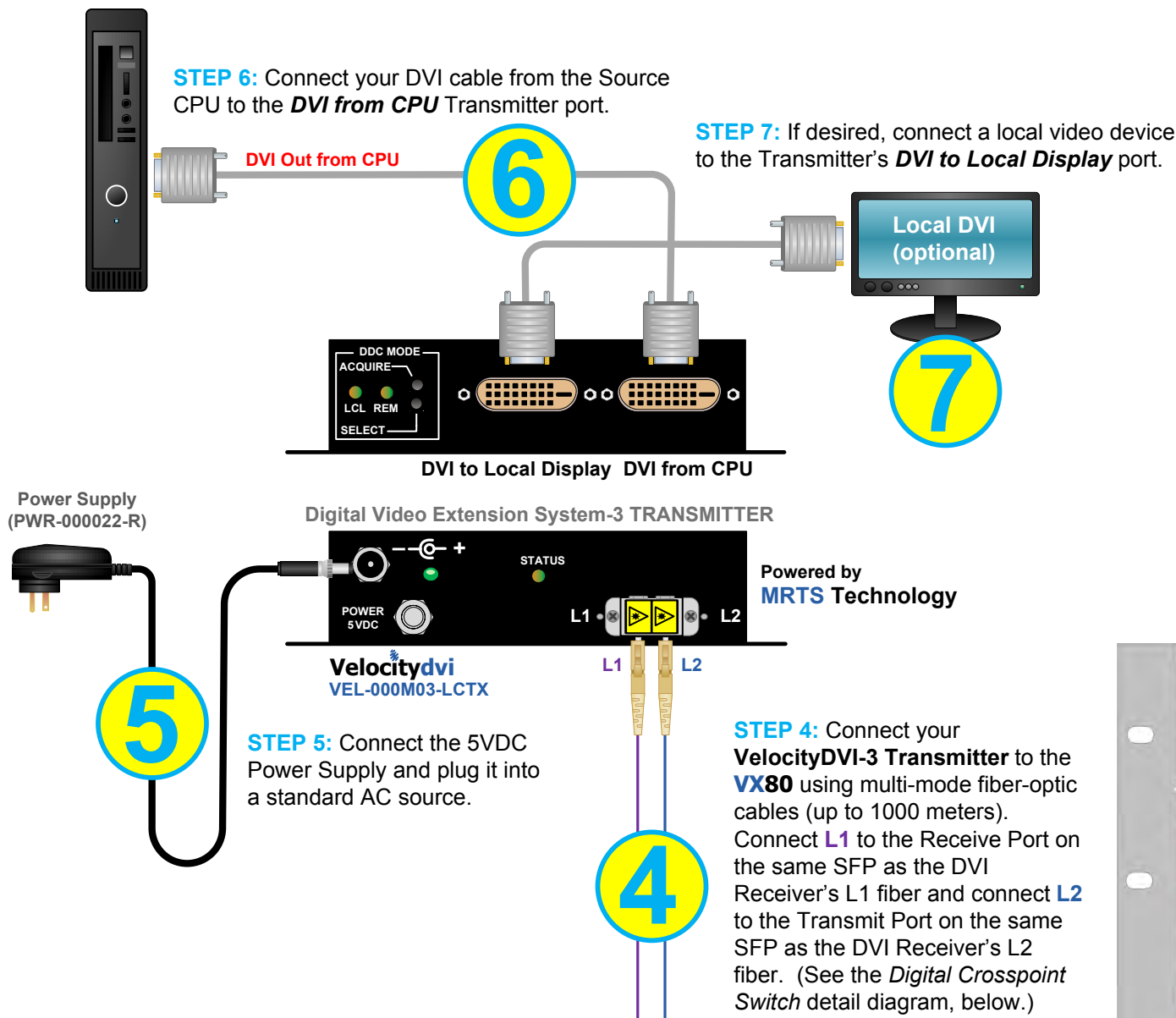

## Single Head RGB/Audio Source

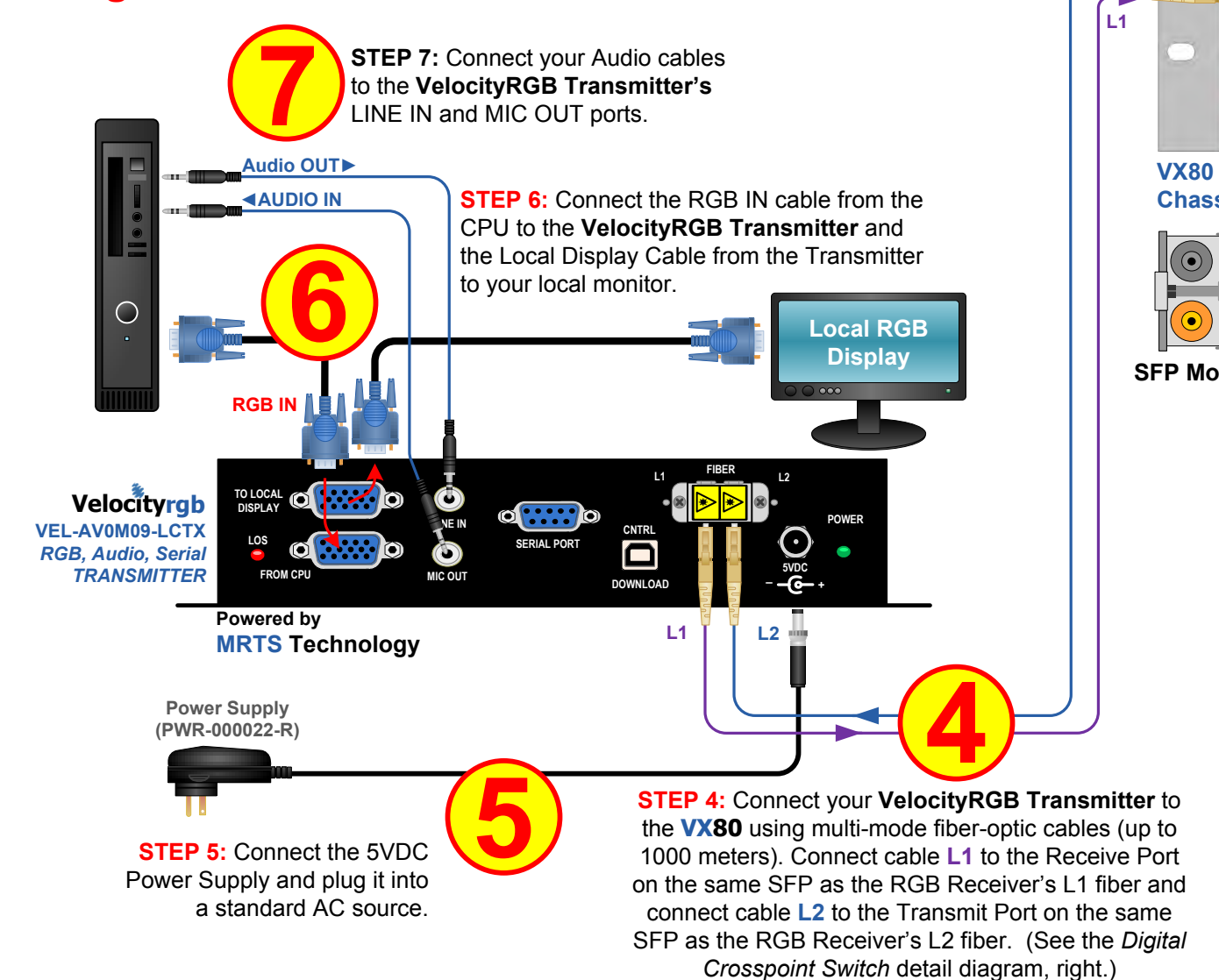

**STEP 9:** Connect both supplied AC Power Cords (PWR-000006-R) to the receptacles located on the VX80's power supplies. Plug each of them into a standard AC source. Verify that all system functions are operating properly.

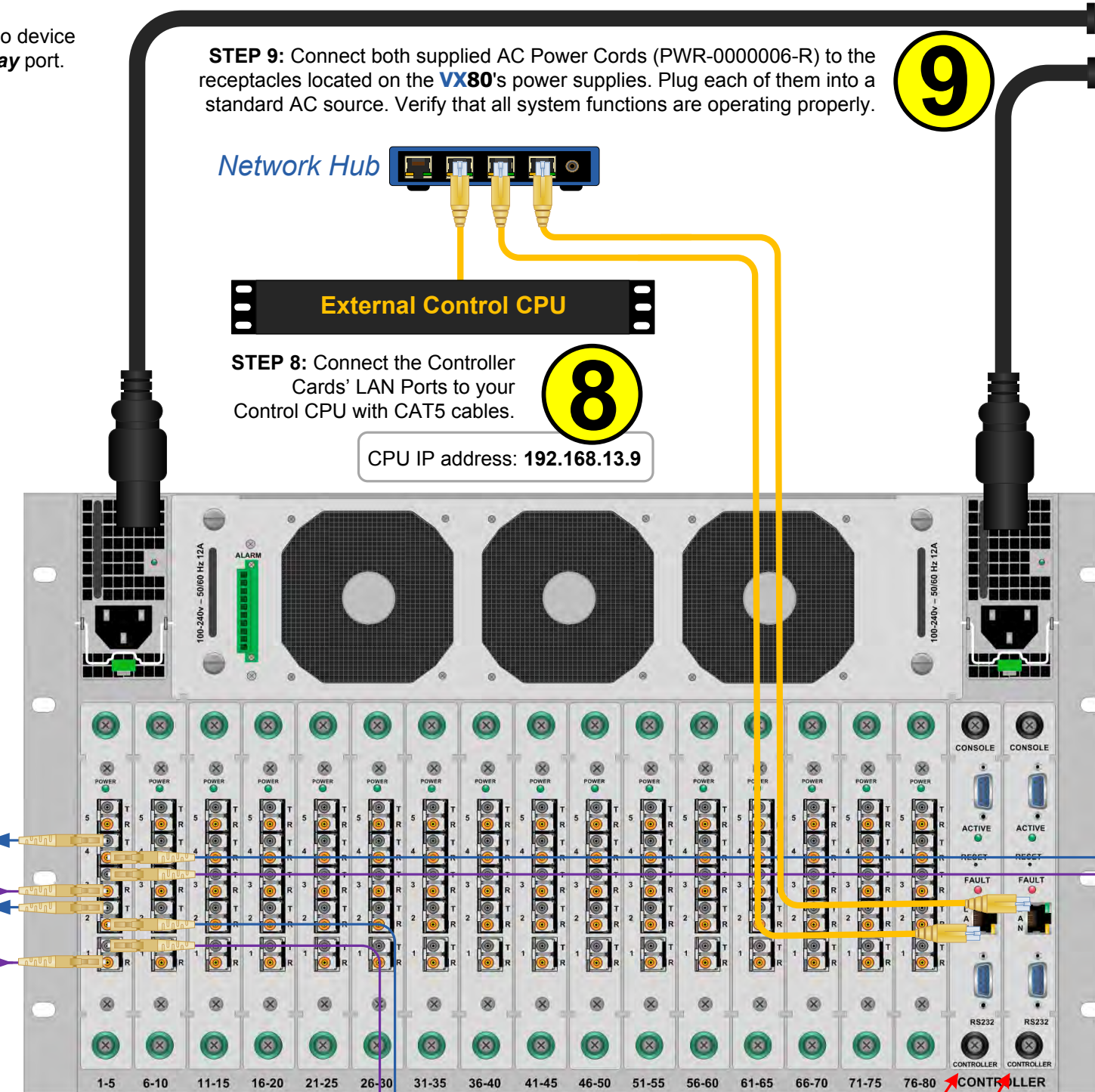
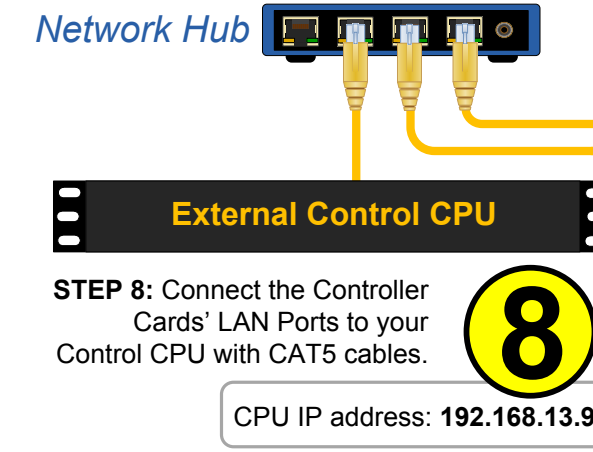

Complete steps 1 through 9 to connect your Thinklogical™ Velocity-3 DVI and your Velocity-9 RGB Fiber-Optic Video Extension Systems through the VX80 KVM Matrix Switch. Follow the same steps to connect any additional devices. Refer to the Digital Crosspoint Switch diagram below to help you determine where to connect your fibers.

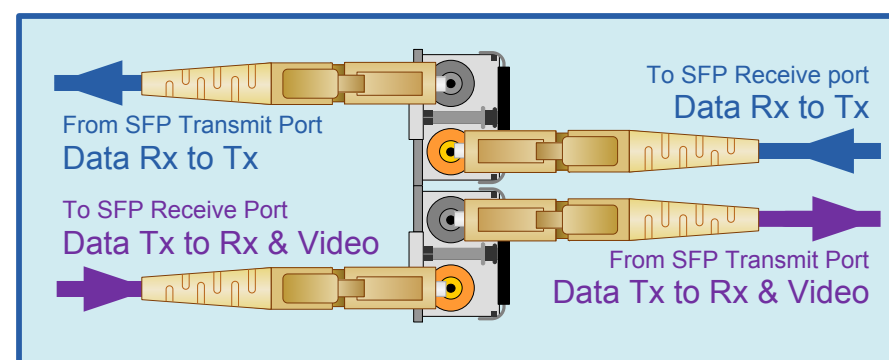

Thinklogical's™ VX80 KVM Matrix Switch features redundant Power Supplies and Controller Modules for uninterrupted performance, even during system reconfiguration, updates or debug. The VX80 remains fully functional with only one Power Supply installed or with one Controller activated.

**NOTE:** When using a single Controller, the module on the left (Primary) must be used.\*

## Single-Head DVI Destination

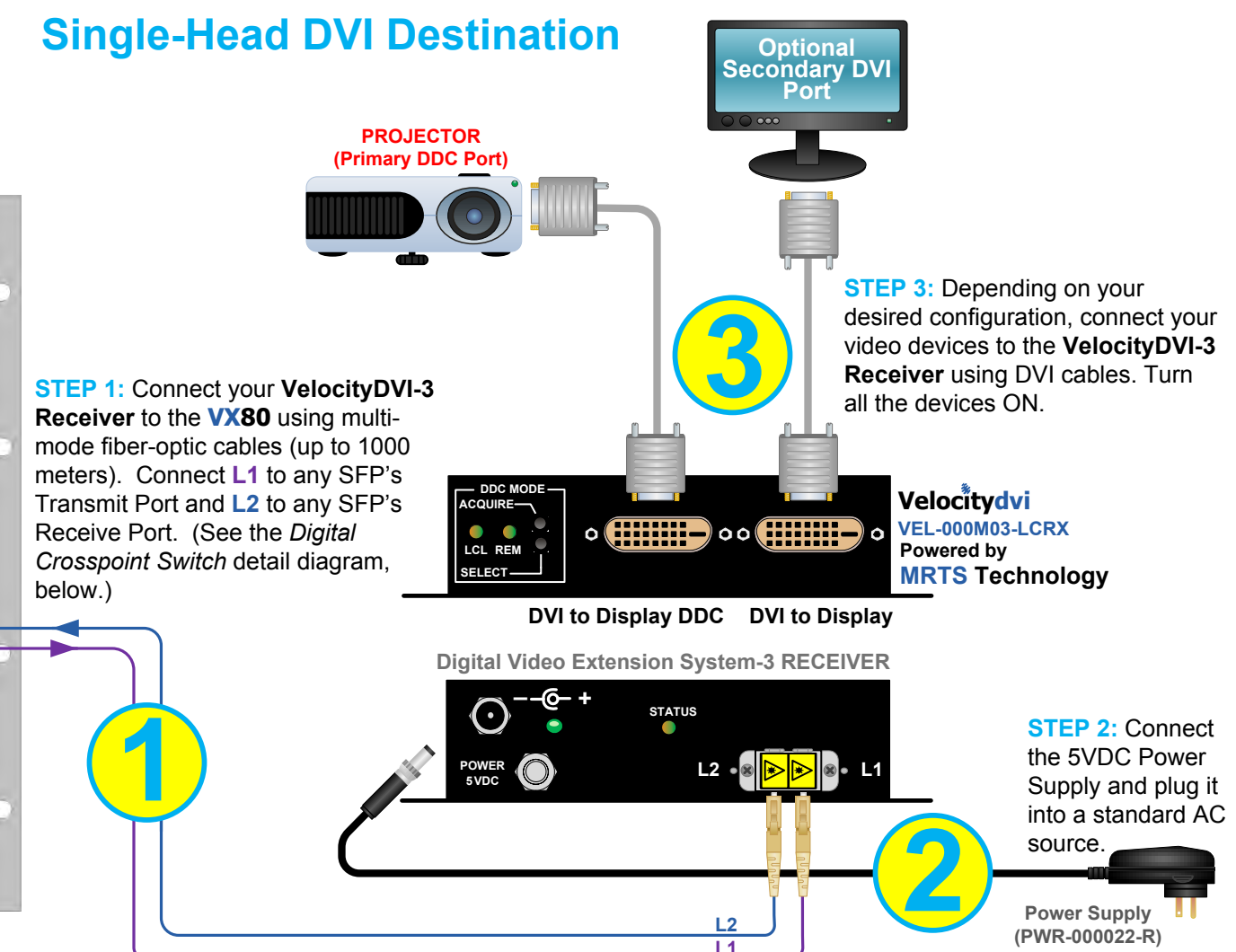

## RGB Video & Audio Destinations

